



Follow the Leader™

INTRODUCING UNISOURCE HEAVY DUTY SEMI AND FULLY AUTOMATIC ARTISAN BREAD SLICERS



- Fully automatic or semi automatic bread slicers
- Heavy duty construction
- Crumb drawer for E-Z cleaning
- Slices soft or heavy breads
- Includes heavy duty caster wheels
- One year parts/labor warranty
- 24/7 Nationwide Service

Direct Phone & Service: (516) 527-3309 • (888) 443-7014 • info@unisourcefoodequipment.com • unisourcefoodequipment.com
170 Wilbur Place, Suite 300, Bohemia, New York, 11716

Follow the Leader™



The Artisan Bread Slicer comes with a "continuous slicing" function allowing to slice all the loaves in one go, without having to reload between each slicing operation.

Raised shoe and high-strength caster with brake.

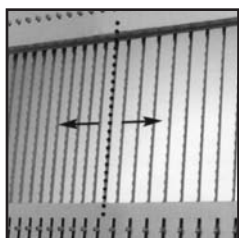

As an optional feature, the largest models (520 and 600) can be supplied in a "double slicing" version, where one half of the slicing width is used for thin slicing, and the other for thick slicing.



A safety bar on the loading side protects the operator when placing the loaves.

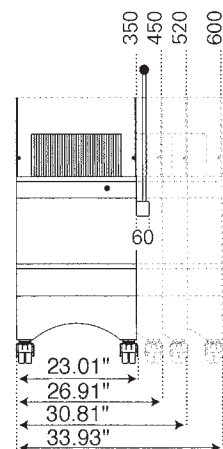
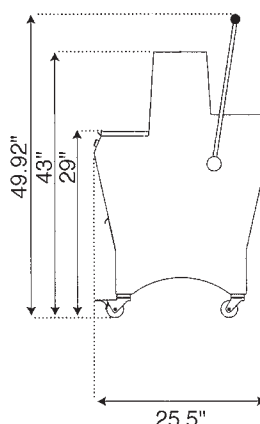

TECHNICAL SPECIFICATIONS

Semi-Automatic	380	450	520	600	450M
Features					
Max. loaf dimensions (L x w x h)	14.82" x 12.09" x 6.24"	17.16" x 12.09" x 6.24"	20.28" x 12.09" x 6.24"	23.4" x 12.09" x 6.24"	17.16" x 11.7" x 6.24"
Power output (in kW)	0.49	0.49	0.49	0.49	1.5
Net weight (in lbs.)	297 lbs.	330 lbs.	363 lbs.	385 lbs.	363 lbs.
Choice of					
Slice thickness (in inches)	from 0.312" to 0.624"	from 0.312" to 0.624"	from 0.351" to 0.624"	from 0.429" to 0.624"	from 0.351" to 0.429"
Loaf height	*low, normal, high	*idem	*idem	*idem	normal
Type of motor	400/220V	single- or 3-phase	single- or 3-phase	single- or 3-phase	3-phase
Options					
Height raised by 3"	•	•	•	•	•
Double slicing version (to be specified)			•	•	
Fully Automatic	380	450	520	600	450M
Features					
Max. loaf dimensions (L x w x h)	17.16" x 12.09" x 6.24"	17.16" x 12.09" x 6.24"	20.28" x 12.09" x 6.24"	23.4" x 12.09" x 6.24"	17.16" x 11.7" x 6.24"
Power output (in kW)	0.49	0.49	0.49	0.49	1.1
Net weight (in lbs.)	297 lbs.	330 lbs.	363 lbs.	385 lbs.	363 lbs.
Choice of					
Slice thickness (in inches)	from 0.273" to 0.624"	from 0.312" to 0.624"	from 0.351" to 0.624"	from 0.429" to 0.624"	from 0.351" to 0.429"
Loaf height	*low, normal, high	*idem	*idem	*idem	normal
Type of motor	400/220V	single- or 3-phase	single- or 3-phase	single- or 3-phase	single- or 3-phase
Options					
Height raised by 3"	•	•	•	•	•
Double slicing version (to be specified)	•	•	•	•	•
Bag opening blowing system		•	•	•	•

Direct Phone & Service: (516) 527-3309 • (888) 443-7014 • info@unisourcefoodequipment.com • unisourcefoodequipment.com
170 Wilbur Place, Suite 300, Bohemia, New York, 11716