



HALSTON DESIGNER SERIES

Single door reach-in freezer



PRODUCT SPECIFICATION

Model	Doors	Capacity (cu.ft)	Shelves	Cabinet Dimensions (Inches / mm)			HP	Voltage	Amps	Cord Length (ft.)	Net Weight (lbs. / kg)
				L	D	H					
UNI-SS23F	1	23	3	27" 686	32" 815	83 1/8" 2111	1/2	110V/60Hz	5.50	6	275 125



In Accordance with
AHRI Std 1200

DOE 2017
Energy Efficiency
Compliant

STANDARD FEATURES

- HEAVY DUTY CONSTRUCTION INCLUDES EXTERIOR SS/430 MATERIAL AND PRE-COATED ALUMINUM FOR INTERIOR
- HIGH QUALITY DIGITAL TEMPERATURE CONTROLLER FROM ITALY
- REVERSIBLE DOORS AND AUTOMATICALLY SELF CLOSE WHEN OPEN LESS THAN 90°
- INSIDE ROUND CORNER DESIGN FOR EASY CLEANING
- HIGH QUALITY BRAND COMPRESSO
- GERMANY WELL-KNOWN BRAND EBM FANS
- REFRIGERATION SYSTEM IS OPTIMIZED TO FUNCTION BETWEEN -8°-0°.
- AUTOMATIC DEFROST SYSTEM
- R290 REFRIGERANT.OZONE FRIENDLY
- ETL approved (conforms to UL-471&NSF-7)
- DOE 2017, Energy efficient compliant

Plan view

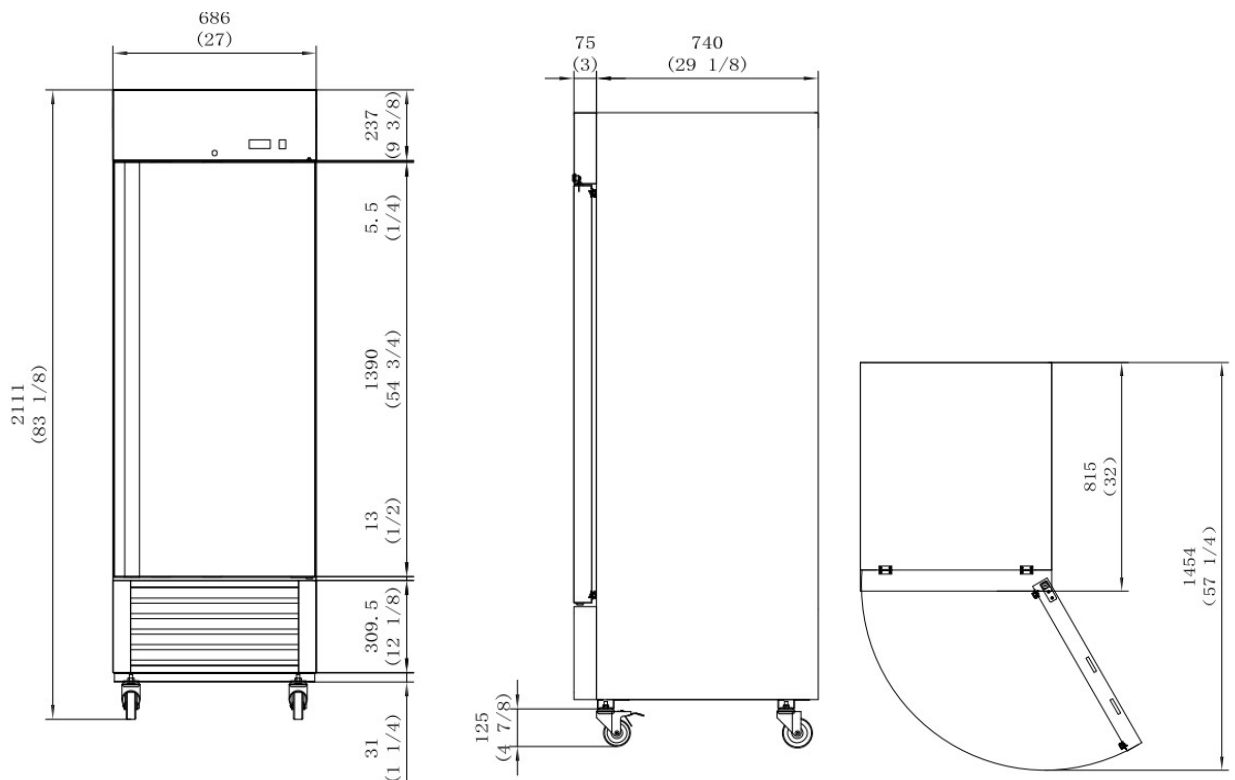

Direct Phone & Services: (516) 527-3309 . (888) 443-7014. info@unisourcefoodequipment.com . unisourcefoodequipment.com

170 Wilbur Place,Suite 300,Bohemia,New York,11716